

Campus Map

Navajo Preparatory School

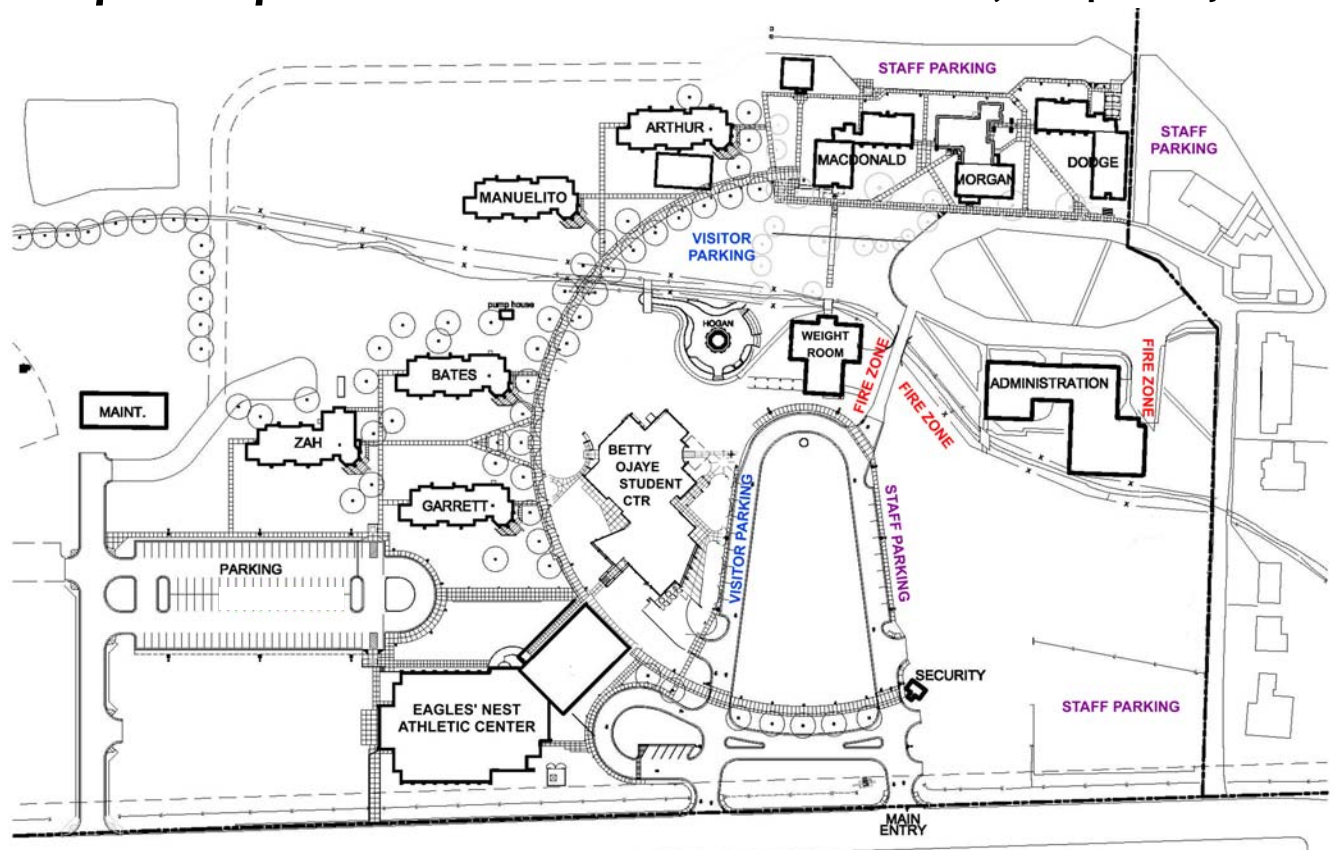

BETTY OJAYE STUDENT CENTER

1ST Floor

- F126 Science Classroom
- F133 Science Classroom
- F135 Asst Dean/Ath Director
- F139 IBO Coordinator
- F142 M. Taylor Health Ctr.
- F163 Registrar
- F165 Dean of Instruction
- F166 Academic Counselor
- Cafeteria
- Student Lounge
- Library

2ND Floor

- F204 Conference Room
- F209 Science Classroom
- F213 PE/Health Classroom
- Mezzanine Computer Lab

MCDONALD HALL

Lower Level

- M121 Operations & Maintenance
- M120 Dean of Student Life
- M120 Asst. Dean of Student Life

1ST Floor

- M221 Social Studies Classroom
- M220 Admission/Development Office
- M254 Social Studies Classroom
- M255 Life Skills Classroom

2ND Floor

- M320 Facility Manager
- M321 Social Studies Classroom

MORGAN HALL

1ST Floor

- G120 Student Success Center
- G153 SSC Kitchen
- G159 Faculty Lounge/Conf. Rm.

2ND Floor

- G220 Navajo Language
- G222 Spanish Language
- G252 Math Classroom
- G253 Math Classroom

DODGE HALL

Lower Level

- D122 Business Office
- D120 Art/Design Classroom
- D154 Computer Science Classroom

1ST Floor

- D225 Executive Director
- D225 Board Room
- D221 Business Manager
- D222 Human Resources/Payroll
- D202 Executive Secretary
- D254 Math Classroom
- D255 English Classroom

2ND Floor

- D323 English Classroom
- D321 English Classroom

DORMITORIES

- Arthur Hall (Males)
- Bates Hall (Females)
- Garrett Hall (Females)
- Manuelito Hall (Males)
- Zah Hall (Females)

EAGLE'S NEST ATHLETIC CENTER

- Athletic Department Secretary
- Music Classroom

ADMINISTRATION BUILDING

1ST Floor

- 125 MDF Room